

Lakeside Planter

The Lakeside Planter is the newest addition to the popular line of site elements designed by award-winning architect, Margaret McCurry. The planter has a simple steel cylinder shell, designed to compliment Lakeside benches and litter bins. The steel shell features decorative grass or leaf patterns incised by state-of-the-art plasma-cutting technology. Special patterns can be created for signature applications. Planters come standard with a black liner and a removable steel body.

Specification:

Materials:
Body - steel

Dimensions

H: 586mm
Dia: 914mm

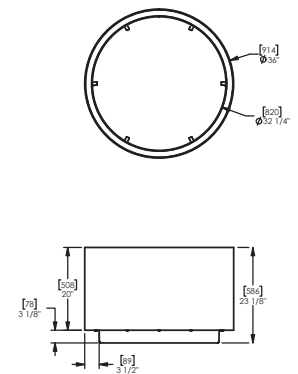

(Technical Drawings for variants available on request)

